



Next Meeting
Wednesday
September 15th, 2021
7:30PM
Public Online Meeting

If you would like to join the meeting please request a meeting link by using the "contact" page on our website no later than Tuesday March 16th.

<https://jackthorn.org/contact/>

JACKTON & THORNTONHALL COMMUNITY COUNCIL AGENDA

- **JTCC members present**
- **Welcome**
- **Apologies**
- **Minutes**
- **Police Report**
- **Treasurer's Report**
- **Chair's Report**
- **Councillors' Reports**
- **Secretary's Report**

Road Closures



Newlands Road will be closed between Jackton Road and No 68 Newlands Road from Monday 20 July until March 2022 for the upgrading/reconstruction and installation of public utility apparatus on Newlands Road associated with the Community Growth Area. Access to residential properties will be maintained at all times from one direction. Diversion via Jackton Road, Eaglesham Road, Greenhills Road, Newlands Road and vice versa.

Junction of Eaglesham Road extending 200m (also Eaglesham Road 100m toward Jackton and 300m toward EK)

Address: JACKTON ROAD, JACKTON, GLASGOW

Actual Start Date: 11/01/2021 **Estimated Duration:** 174 Working Day(s)

Description: Installation of new roundabout and associated upgrade works associated with the East Kilbride Community Growth Area`

A726 GLASGOW SOUTHERN ORBITAL East Glasgow Road to Redwood

Address:A726 GSO EAST KILBRIDE, GLASGOW

Promoter:Transport Scotland - M77 DBFO

Expected Start Between:26/08/2021 - 25/11/2021 **Estimated Duration:**2 Working Day(s)

Description:Works are for Carriageway surfacing ,From Glasgow Road Redwood

Planning Applications



[Demolition of stables and erection of 2 no. detached dwellinghouse and detached garages](#)

Land 65M WNW Of Easter House Jackton Road Jackton
Glasgow South Lanarkshire

Ref. No: P/21/1562 | Received: Tue 24 Aug 2021 | Validated:
Wed 01 Sep 2021 | Status: Registered

[Erection of extension to garden store building \(Listed building consent\)](#)

Bystone Peel Road Thorntonhall G74 5AG

Ref. No: P/21/1453 | Received: Thu 05 Aug 2021 | Validated: Fri 13 Aug 2021 | Status:
Withdrawn

[Erection of detached dwellinghouse and associated parking on land between 5 and 7 Wellknowe Road, Thorntonhall](#)

7 Wellknowe Road Thorntonhall G74 5AH

Ref. No: P/21/1447 | Received: Wed 04 Aug 2021 | Validated: Tue 17 Aug 2021 | Status:
Registered

[Installation of an external gas meter box \(Listed building consent\)](#)

Bystone Peel Road Thorntonhall G74 5AG

Ref. No: P/21/1449 | Received: Wed 04 Aug 2021 | Validated: Fri 13 Aug 2021 | Status:
Registered

[Erection of non-illuminated 2500mm x 1250mm flat board sign with printed panel on 89mm diameter pole](#)

Land 145M Northeast Of Peel Farm Cottage Peel Road Thorntonhall Glasgow South
Lanarkshire

Ref. No: P/21/1253 | Received: Wed 30 Jun 2021 | Validated: Mon 09 Aug 2021 | Status:
Registered

P/21/0012/PAN | **Proposed residential development** with associated access roads, landscaping, open space and other required infrastructure (Proposal of application notice) | Land Off Barbana Road East Kilbride

Mcnally are hosting a public exhibition online of the proposed development, which can be accessed from the following webpage <http://www.mcinally-associates.co.uk/pp/index.html> This webpage (which will include the public exhibition boards) will be available to view **between the dates of Monday 13th September to Monday 4th October**. In addition, members of the project team will be available via a live-chat facility between 10am and 1pm on 16th September 2021 to explain the proposals in detail and answer any questions you may have. You can also submit any questions both via e-mail to <mailto:advice@mcinally->

associates.co.uk or on the webpage outlined above. Members of the public wishing to make comments on the proposal can do so via the methods outlined above by Monday 25th October.

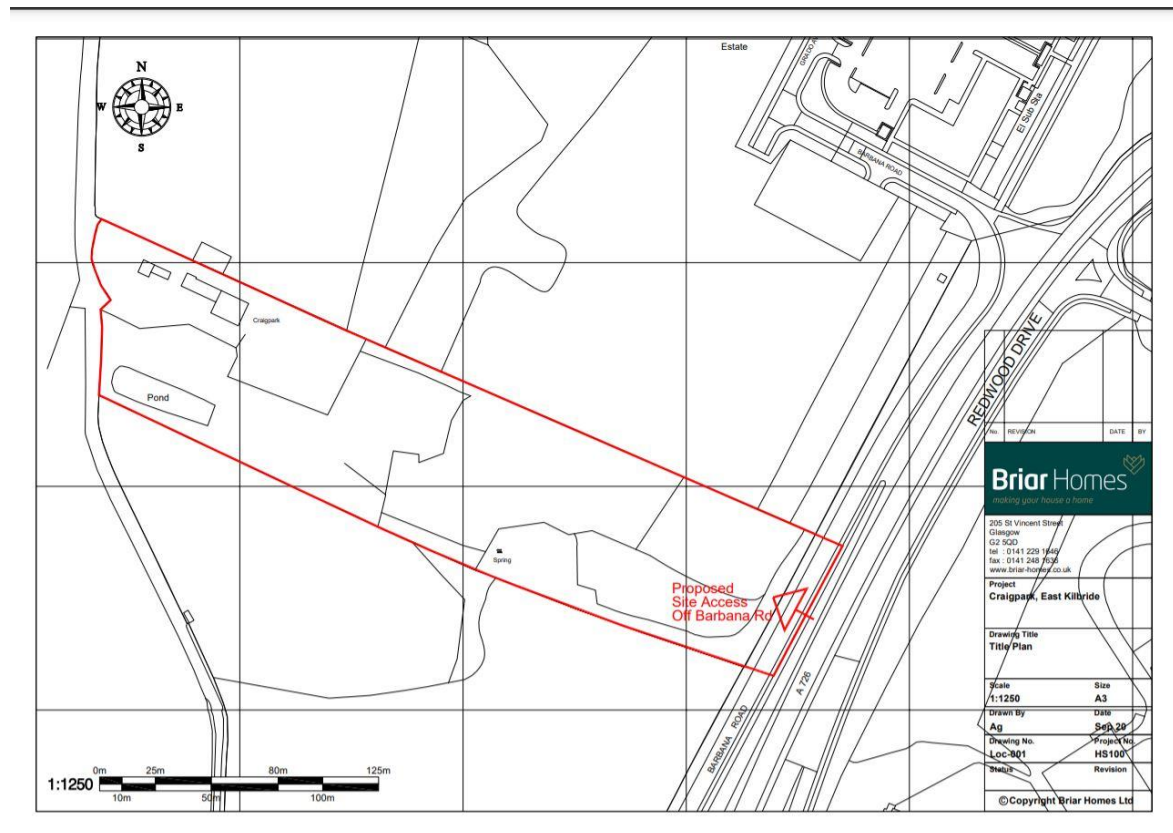

Search <https://www.southlanarkshire.gov.uk/Planning> using the planning reference number for further information on each planning application.

Correspondence:

South Lanarkshire Council - Winter Resilience – Assistance to Communities Clearing Ice and Snow.

AOB

Litter picking in the community